



TL-2800 Portable Caregiver Alarm With Motion Sensor

WARNING: Failure to comply with warning may result in injury or death. This device is not suitable for all individuals. Other devices may be required. This device is not a substitute for visual monitoring by caregiver. The manufacturer does not claim that this device will stop elopement and/or stop falls. This device is designed to augment caregivers' comprehensive resident mobility management program. **Test this device before each use. Read the instructions and Legal Disclaimer.**

The Smart Caregiver Corporation TL-2800 Motion Sensor to Receiver is designed to be installed by the end-user. As such, it is the entire responsibility of the buyer to insure that the system is properly installed and tested. Further, the system is not designed to replace good caregiving practices including, but not limited to:

- A.) Direct patient supervision
- B.) Adequate training for staff personnel for elopement
- C.) Testing of the system before each use

WHERE PERMISSIBLE, IT IS THE SELLER'S INTENT TO LIMIT ANY LIABILITY FOR SPECIAL, CONSEQUENTIAL OR INCIDENTAL ECONOMIC DAMAGES TO REFUND OF THE PURCHASE PRICE OR REPLACEMENT OF THE GOODS. SELLER DISCLAIMS ANY LIABILITY FOR COMPENSATORY OR OTHER DAMAGES ARISING OUT OF THE USE OF THE GOODS.

WARNING: The manufacturer does not claim that this device will stop elopement and/or stop falls. This device is designed to augment caregivers' comprehensive resident mobility management program.

Limited Warranty: Seller warrants that the goods sold will be free from defects of workmanship and manufacturing, for a period of one year from the date of sale. Other than this limited warranty, seller makes no express or implied warranties. Except for this limited warranty, NO EXPRESS OR IMPLIED WARRANTIES ARE GIVEN AND NO AFFIRMATION OF SELLER, BY WORDS OR ACTION, WILL CONSTITUTE A WARRANTY. THE GOODS BEING PURCHASED ARE BEING SOLD ON A "WITH ALL FAULTS" BASIS. THE ENTIRE RISK AS TO THE QUALITY AND PERFORMANCE OF THE GOODS IS WITH THE BUYER. SHOULD THE GOODS PROVE DEFECTIVE FOLLOWING THEIR PURCHASE, THE BUYER, AND NOT THE MANUFACTURER, DISTRIBUTOR OR RETAILER, ASSUMES THE ENTIRE COST OF ALL NECESSARY INSTALLATION, SERVICING OR REPAIRS.

Need Set-up Help?

Call Our Friendly Customer Service Reps at (800) 650-3637



SMART CAREGIVER CORPORATION

1229 North McDowell Blvd., Petaluma, CA. 94954 | Tel: 800-650-3637
sales@smartcaregiver.com | www.smartcaregiver.com

November 16, 2015 12:23 PM



TL-2800 Portable Caregiver Alarm With Motion Sensor

WARNING: Failure to comply with warning may result in injury or death. This device is not suitable for all individuals. Other devices may be required. This device is not a substitute for visual monitoring by caregiver. The manufacturer does not claim that this device will stop elopement and/or stop falls. This device is designed to augment caregivers' comprehensive resident mobility management program. **Test this device before each use. Read the instructions and Legal Disclaimer.**

The Smart Caregiver Corporation TL-2800 Motion Sensor to Receiver is designed to be installed by the end-user. As such, it is the entire responsibility of the buyer to insure that the system is properly installed and tested. Further, the system is not designed to replace good caregiving practices including, but not limited to:

- A.) Direct patient supervision
- B.) Adequate training for staff personnel for elopement
- C.) Testing of the system before each use

WHERE PERMISSIBLE, IT IS THE SELLER'S INTENT TO LIMIT ANY LIABILITY FOR SPECIAL, CONSEQUENTIAL OR INCIDENTAL ECONOMIC DAMAGES TO REFUND OF THE PURCHASE PRICE OR REPLACEMENT OF THE GOODS. SELLER DISCLAIMS ANY LIABILITY FOR COMPENSATORY OR OTHER DAMAGES ARISING OUT OF THE USE OF THE GOODS.

WARNING: The manufacturer does not claim that this device will stop elopement and/or stop falls. This device is designed to augment caregivers' comprehensive resident mobility management program.

Limited Warranty: Seller warrants that the goods sold will be free from defects of workmanship and manufacturing, for a period of one year from the date of sale. Other than this limited warranty, seller makes no express or implied warranties. Except for this limited warranty, NO EXPRESS OR IMPLIED WARRANTIES ARE GIVEN AND NO AFFIRMATION OF SELLER, BY WORDS OR ACTION, WILL CONSTITUTE A WARRANTY. THE GOODS BEING PURCHASED ARE BEING SOLD ON A "WITH ALL FAULTS" BASIS. THE ENTIRE RISK AS TO THE QUALITY AND PERFORMANCE OF THE GOODS IS WITH THE BUYER. SHOULD THE GOODS PROVE DEFECTIVE FOLLOWING THEIR PURCHASE, THE BUYER, AND NOT THE MANUFACTURER, DISTRIBUTOR OR RETAILER, ASSUMES THE ENTIRE COST OF ALL NECESSARY INSTALLATION, SERVICING OR REPAIRS.

Need Set-up Help?

Call Our Friendly Customer Service Reps at (800) 650-3637



SMART CAREGIVER CORPORATION

1229 North McDowell Blvd., Petaluma, CA. 94954 | Tel: 800-650-3637
sales@smartcaregiver.com | www.smartcaregiver.com

November 16, 2015 12:23 PM

Quick Start Instructions

TL-2800

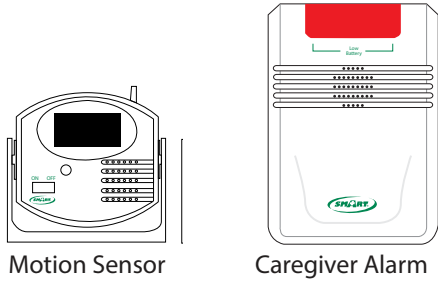

Motion Sensor

Caregiver Alarm

Portable Caregiver Alarm With Motion Sensor For The Elderly

Place 3 new "AA" battery in the motion sensor.

Place three new "C" batteries in the caregiver alarm or plug the receiver into a wall outlet using an AC-04 adapter (sold separately).

NOTE: The outside lights on the top of the alarm will blink if the "C" batteries need to be replaced

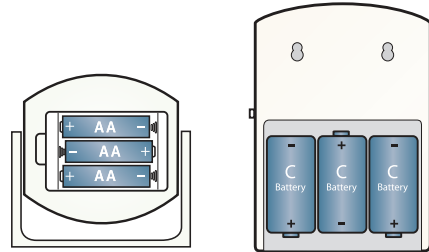

Mount motion sensor and caregiver alarm to the wall using screws and/or the included adhesive squares.

**Caregiver Alarm is portable and can be carried by caregiver if desired*

The receiver may be placed up to 300 feet from the motion sensor. Environmental conditions can change the effective range of this wireless equipment; **test the system before each use.**



The volume of the alert can be adjusted using the switch on the left side of the caregiver alarm. Volume can be set at low (LO), medium (MI) or high (HI).

- Each time the infrared field of the motion sensor is interrupted, the caregiver alarms outside lights will blink quickly and go off and the center light will stay solid will chiming repeatedly.
- Reset the caregiver alarm by moving the switch to "OFF", wait 30 seconds and then back to "CHIME" to reactivate it.



Test system prior to each use.

Quick Start Instructions

TL-2800

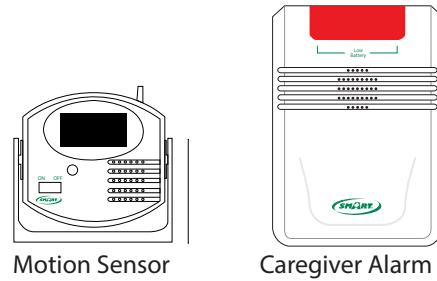

Motion Sensor

Caregiver Alarm

Portable Caregiver Alarm With Motion Sensor For The Elderly

Place 3 new "AA" battery in the motion sensor.

Place three new "C" batteries in the caregiver alarm or plug the receiver into a wall outlet using an AC-04 adapter (sold separately).

NOTE: The outside lights on the top of the alarm will blink if the "C" batteries need to be replaced

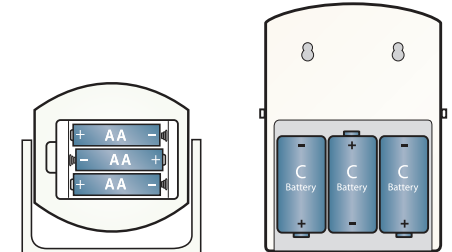

Mount motion sensor and caregiver alarm to the wall using screws and/or the included adhesive squares.

**Caregiver Alarm is portable and can be carried by caregiver if desired*

The receiver may be placed up to 300 feet from the motion sensor. Environmental conditions can change the effective range of this wireless equipment; **test the system before each use.**



The volume of the alert can be adjusted using the switch on the left side of the caregiver alarm. Volume can be set at low (LO), medium (MI) or high (HI).

- Each time the infrared field of the motion sensor is interrupted, the caregiver alarms outside lights will blink quickly and go off and the center light will stay solid will chiming repeatedly.
- Reset the caregiver alarm by moving the switch to "OFF", wait 30 seconds and then back to "CHIME" to reactivate it.



Test system prior to each use.

