



SMART CAREGIVER CORPORATION



- Stand-Alone Motion Sensing Exit Alarm with swivel bracket
- Use for bedside, hallways and doorways
- Chime Alert

TL-2700 Motion Sensing Exit Alarm

Installation and Use Instructions

TL-2700 Motion Sensing Exit Alarm

WARNING: Failure to comply with the warning may result in injury or death. This device is not suitable for all individuals. Other devices may be required. This device is not a substitute for visual monitoring by a caregiver. The manufacturer does not claim that this device will stop elopement and/or stop falls. This device is designed to augment caregivers' comprehensive resident mobility management program. **Test this device before each use. Read the instructions and Legal Disclaimer.**

The Smart Caregiver Corporation TL-2700 Motion Sensing Exit Alarm is designed to be installed by the end user. As such, it is the entire responsibility of the buyer to insure that the system is properly installed and tested. Further, the system is not designed to replace good caregiving practices including, but not limited to:

- A.) Direct patient supervision**
- B.) Adequate training for staff personnel for fall prevention and elopement**
- C.) Testing of the system before each use**

WHERE PERMISSIBLE, IT IS THE SELLER'S INTENT TO LIMIT ANY LIABILITY FOR SPECIAL, CONSEQUENTIAL OR INCIDENTAL ECONOMIC DAMAGES TO REFUND OF THE PURCHASE PRICE OR REPLACEMENT OF THE GOODS. SELLER DISCLAIMS ANY LIABILITY FOR COMPENSATORY OR OTHER DAMAGES ARISING OUT OF THE USE OF THE GOODS.

WARNING: The manufacturer does not claim that this device will stop elopement and/or stop falls. This device is designed to augment caregivers' comprehensive resident mobility management program. This product is to be used by a licensed caregiver only.

Limited Warranty: Seller warrants that the goods sold will be free from defects of workmanship and manufacturing, for a period of 90 days from the date of sale. Other than this limited warranty, seller makes no express or implied warranties. Except for this limited warranty, NO EXPRESS OR IMPLIED WARRANTIES ARE GIVEN AND NO AFFIRMATION OF SELLER, BY WORDS OR ACTION, WILL CONSTITUTE A WARRANTY. THE GOODS BEING PURCHASED ARE BEING SOLD ON A "WITH ALL FAULTS" BASIS. THE ENTIRE RISK AS TO THE QUALITY AND PERFORMANCE OF THE GOODS IS WITH THE BUYER. SHOULD THE GOODS PROVE DEFECTIVE FOLLOWING THEIR PURCHASE, THE BUYER, AND NOT THE MANUFACTURER, DISTRIBUTOR OR RETAILER, ASSUMES THE ENTIRE COST OF ALL NECESSARY INSTALLATION, SERVICING OR REPAIRS.



SMART CAREGIVER CORPORATION

1229 North McDowell Blvd., Petaluma, CA. 94954 | Tel: 800-650-3637

sales@smartcaregiver.com | www.smartcaregiver.com

See other side for Quick Start Instructions

TL-2700 Motion Sensor

The TL-2700 Motion Sensing Exit Alarm is extremely easy to use and install. With a range of 30 feet (depending on the environment) this compact wireless unit alerts caregiver when a resident vacates a bed, chair or the caregivers designated area. When the Motion Sensing Exit Alarm is triggered an alarm will immediately sound. Exit Alarm has adjustable tones and can be turned to OFF mode. An extendable mounting bracket is available to help eliminate false alarms. The Motion Sensor comes with a 90 day warranty.

TL-2700 Contents:

- Motion Sensing Exit Alarm
- Swivel Bracket

Optional Accessories:

- Mounting Bracket Clamp
- Extendable Mounting Bracket

IMPORTANT OPERATIONAL WARNING: This monitor will only alarm while motion is detected by the Exit Alarm. The alarm will only sound for a short period of time. Once the alert sounds, it is important to check on the resident IMMEDIATELY.

Need Set-up Help? (800) 650-3637

1 How to Activate

- Remove sensor from bracket by gently lifting the bracket over the square pegs. See diagram.
- Insert 9V battery (not included) into battery compartment. (See diagram)
- Close the battery cover and put the bracket back on and wait 10 seconds before use.

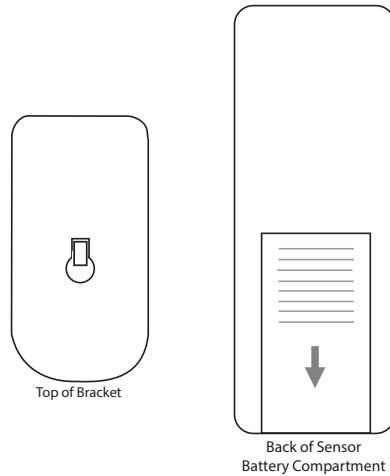

2 Adjust Settings

- The chime mode and chime mode sound like a doorbell.
- The second setting is OFF mode.
- Please note that the monitor will be shipped with the alarm volume set at 90 decibels per foot (90 decibels is the legally accepted occupational noise allowance).
- Slide switch to the desired mode.

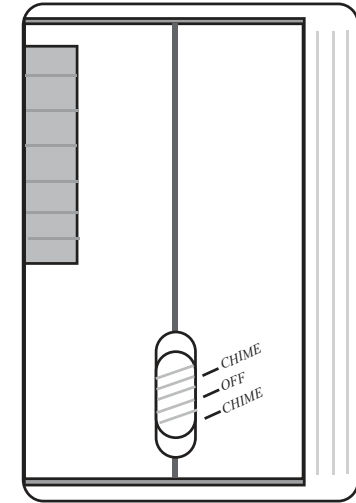

3 Sensor Placement

- Mount exit alarm in the desired monitoring area such as residents bedside, chair side or doorway. Make sure the resident cannot tamper with the monitor.
- When installed correctly the unit has a detection coverage of approximately 30 feet (depending on the environment).
- Test all settings before using.

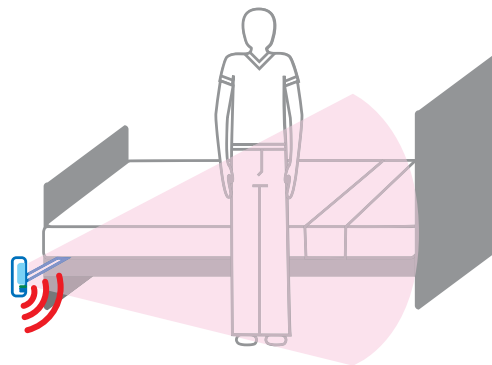

4 Exit Alarm Maintenance

- Do not disassemble the main unit.
- Do not install unit in direct sunlight or rain. Avoid places where a drastic change of temperature may occur.
- Do not install unit near heat sources such as stove tops, fans, radiators or illuminators.
- Do not stab or poke lens or speaker.
- Remove battery when not in use for more than a week.

